

**EMERGENCY FIRST STAGE PANEL BOARD (THIRD SOURCE) 100 cu.mt/hr**

THE EMERGENCY FIRST STAGE PANEL BOARD (THIRD SOURCE) single version, are conceived and manufactured according with MDD 93/42 EEC and related norms ISO 7396-1 and UNI EN ISO 10524-2

The single first stage panel boards are normally used as emergency third source for the central stations, cylinders type.

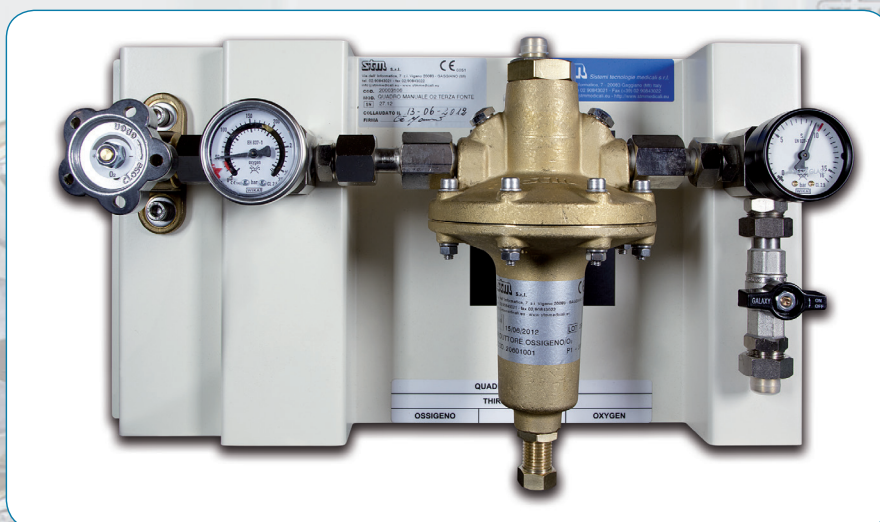
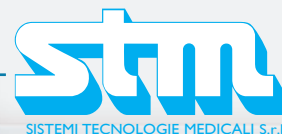

CODE	DESCRIPTION	MAX INLET PRESSURE	OUTLET PRESSURE	LOAD, NORMAL cu.mt/hr
QRI - 0002	Emergency first stage panel board, Oxygen	230 bar	8 bar	100
QRI - 0008	Emergency first stage panel board, Air	230 bar	8 bar	100
QRI - 0005	Emergency first stage panel board, Nitrous Oxide	100 bar	8 bar	100
QRI - 0011	Emergency first stage panel board, Carbon Dioxide	100 bar	8 bar	100
QRI - 0014	Emergency first stage panel board, Nitrogen	230 bar	8 bar	100
20601071	METAL COVER LAQUERED FOR RESERVE PANEL BOARD 180/100 CU.MT./HR			

The structure is realized in varnished stainless steel.

- . High pressure sectioning valve, double rod type for reducing the friction during opening and closing operations.
- . Manometer with alarm contact to 20/30 bar, according with supplying medical gas, signalling "empty manifold".
- . High load pressure regulator with hot pressed brass body.
- . Manometer scale 0-16 bar showing regulator outlet pressure.

All manometers have a safety glass.

The regulator has a built-in PTFE membrane.

Safety valve directly mounted on the regulator.

Low pressure valve, realized in brass with a stainless steel ball, mounted down-stream the regulator.

## EMERGENCY FIRST STAGE PANEL BOARD (THIRD SOURCE) 100 cu.mt/hr

- 1) MANIFOLD RELIEF VALVE
- 2) EMERGENCY MANIFOLD
- 3) RACK
- 4) PIGTAIL
- 5) GAS CYLINDER
- 6) EMERGENCY MANUAL FIRST STAGE PANEL BOARD

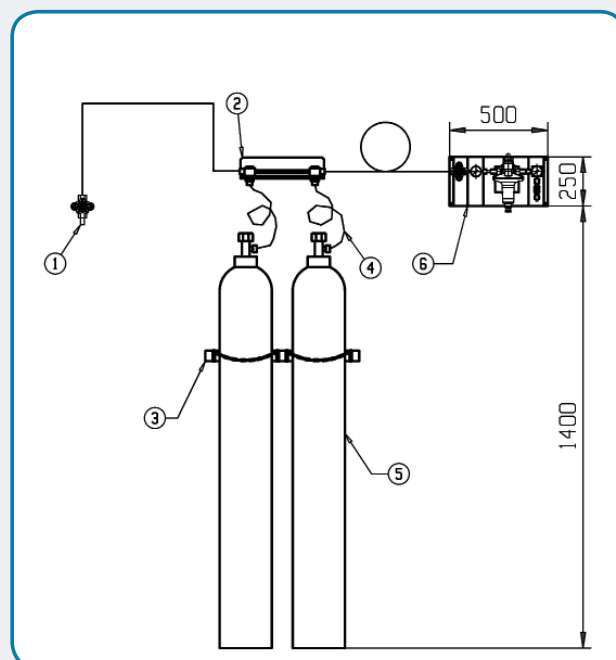
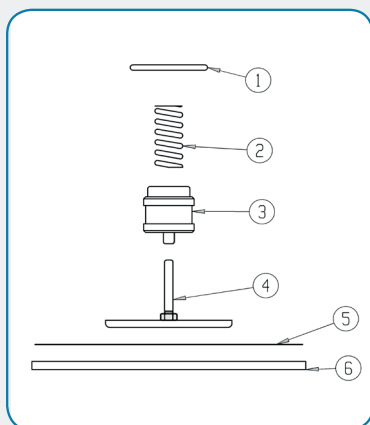

NA	O2-AIR-N2 REGULATOR KIT, CODE 20601060	CO2-N2O REGULATOR KIT, COD. 20601075
1	OR 3 I25 VITON	OR 3 I25 NBR
2	SHUTTER SPRING	SHUTTER SPRING
3	SHUTTER	SHUTTER
4	MEMBRANE PUSH-PLATE	MEMBRANE PUSH-PLATE
5	TEFLON MEMBRANE	TEFLON MEMBRANE
6	CANVAS RUBBER MEMBRANE	CANVAS RUBBER MEMBRANE

## EMERGENCY FIRST STAGE PANEL BOARD SPARES

CODE 26401017	HIGH PRESSURE CONTACT MANOMETER FOR 315 BAR SIGNALS
CODE 26404018	HIGH PRESSURE CONTACT MANOMETER FOR 100 BAR SIGNALS
CODE 26404016	LOW PRESSURE MANOMETER, 16 BAR